

LOCKED MEANS LOCKED.

Weak Point

76% of intruders enter via a door

Quiet Entry

31% had the lock forced

Opportunity

43% occur when no-one is home

Cost

£2438 average loss



BS EN
1303:2005



TS007:2014



Anti-Bump



Anti-Snap



Anti-Pick



Anti-Drill



Sold Secure
Diamond



Secured by
Design



Total Security

RECOMMENDED W

Maximum Security Cylinder

For maximum protection and peace of mind, the Fortress cylinder from ERA has been independently tested to meet the industry's highest standards.

This high performance euro profile cylinder has six hardened high security pins for the ultimate Anti-Pick and Anti-Bump resistance, 12 Anti-Drill pins and a Defence zone to leave the lock inaccessible to intruders, making this a formidable Anti-Snap Cylinder.



Cylinder Security Level

Look out for the TS007 star rating and kitemark logo that indicates the security level of a cylinder.

Maximum security: 3 Star Cylinder, BS Kitemark

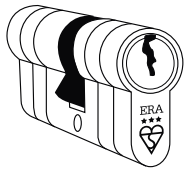

The highest protection for a door, use with a standard handle to give you ultimate resistance to:



Mid security: 1 Star Cylinder, BS Kitemark

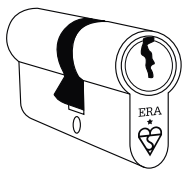

Mid-range protection for a door



Standard: 6 Pin Cylinder, no BS Kitemark



Everyday locking solution, offering standard operation but limited security for a door:



What is BS EN 1303



BS EN 1303 is a British Standard awarded to cylinder locks. It details grades of performance and associated tests. To meet the standard a cylinder must be independently tested to the required grade by accredited locksmiths before kitemark is rewarded.

What is TS007



The Door and Hardware Federation and the Glass and Glazing Federation together launched this performance standard aimed at giving guidance for homeowners. TS007 is aimed at protecting cylinder locks against all known methods of forced entry, including picking, manipulation, bumping and snapping.

Secured by Design and Sold Secure Diamond



Secured by Design



Sold Secure Diamond

Secured by Design (SBD) and Sold Secure Diamond (SSD) are initiatives aimed at raising security performance within the industry. SBD is operated by the Association of Chief Police Officers and SSD is a Master Locksmiths Association Programme. Reputable locksmiths work in partnership with these associations so homeowners can be confident about the security of their cylinder.

WITH CONFIDENCE

Anti-Snap

Two sacrificial zones.
Lock remains intact
when snapped

Defence Zone

Triggered under attack.
Blocks cam to secure.
Cylinder can still be
unlocked from the inside

High Performance

Independently
tested to the highest
standards

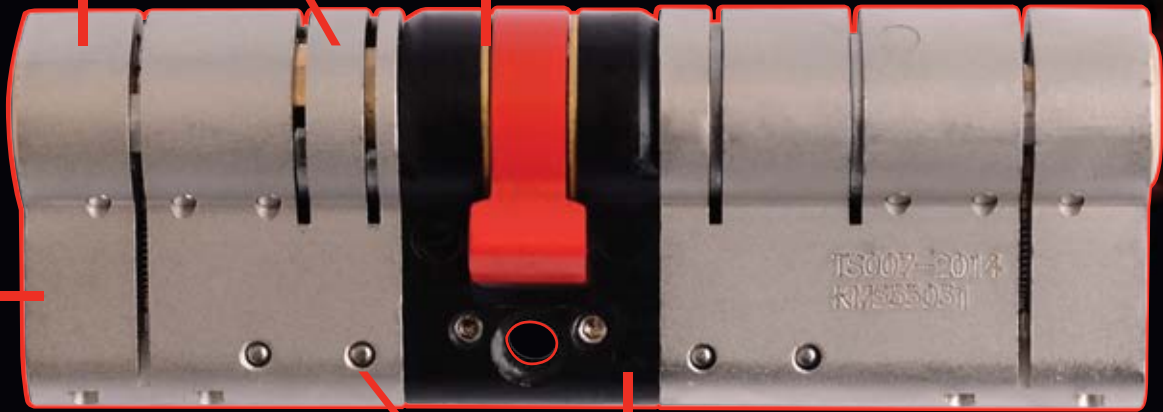

Anti-Drill

12 Hardened
Anti-drill pins

Anti-Pick & Anti-Bump

6 pin defence technology
98,246 key differs

Strength

Molybdenum core.
25% stronger
than steel



The **BEST**
protection
against **Snapping**

Two sacrificial sections on the cylinder and a defence zone that blocks the cam with a relocking pin, prevents intruders from accessing inner workings of the lock, whilst leaving the cylinder intact and operable from the inside giving superb Anti-Snap protection.

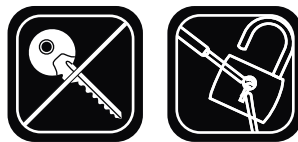

The **BEST** protection
against **Bumping**
and **Picking**

With six trap pins and 98,000 key differs, Bumping the pins or Picking the lock becomes time consuming and therefore redundant, giving great Anti-Bump and Anti-Pick protection.



The **BEST**
protection
against **Drilling**

Hardened pins protect from an intruder drilling through the keyhole to access the lock. Multiple pins prevent a drill bit penetrating the lock, ensuring the cylinder offers excellent Anti-Drill protection.

Why Choose ERA

Unfortunately, in today's world, snapping a lock is all too easy. Whilst some cylinders may appear the same on the surface it's vital that you look at the differences between them to determine the right one.



Tested to the highest standards and offering the ultimate defence against snapping, picking, bumping and drilling, the ERA Fortress is the only 3* euro cylinder recommended by the Neighbourhood Watch.



Also available in Thumbturn and Single Cylinder

Fortress 3 Star BS Euro Profile Cylinder

Dimensions

Single			Double			Thumbturn		
A	B	C	A	B	C	A	B	C
35	10	45	35	35	70	35	35	70
40	10	50	35	35	70	35	35	70
45	10	55	35	40	75	35	40	70
50	10	60	35	45	80	35	45	70
55	10	65	40	40	80	40	40	70
60	10	70	40	45	85	40	40	75
			40	50	90	40	45	80
			40	55	95	40	45	80
			45	45	90	40	50	85
			45	45	90	40	55	90
			45	50	95	40	55	95
			45	50	95	45	60	90
			45	50	95	45	45	90
			45	50	95	45	45	95
			50	45	95	45	50	95
			50	45	95	45	50	95
			50	50	100	45	50	95
			50	50	100	45	50	95
			55	45	100	45	55	95
						45	55	100
						50	50	100
						50	50	100

Fortress 3 Star BS Single Euro Profile Cylinder

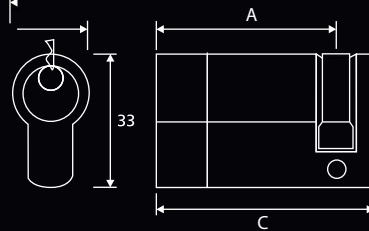

Fortress 3 Star BS Double Euro Profile Cylinder

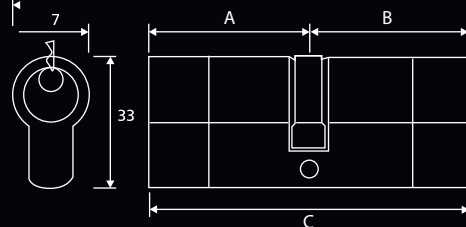

Fortress 3 Star BS Double Euro Profile Thumbturn Cylinder

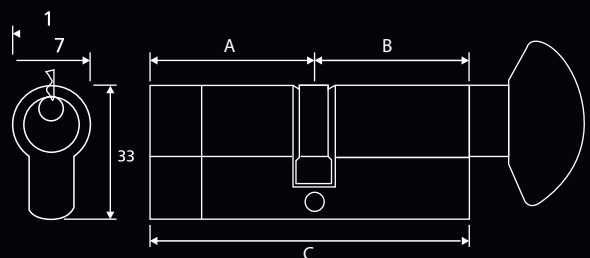

All dimensions are in mm and are nominal.
ERA reserves the right to change specification without notice.
It is the responsibility of the door manufacturer to ensure that the finished product meets any required safety and performance specification.

Total Security

for your home

ERA Home Security, Valiant Way, Wolverhampton, West Midlands. WV9 5GB
Tel: +44 1922 490000 Email: info@erahomesecurity.com www.eraeverywhere.com

British Standard 3 Star Anti Snap Euro Profile Cylinder



Features

- High performance euro profile locking cylinder guaranteed for ease of application and long term trouble free performance
- Designed with 6 pin 'bumping' resistance security, the anti pick, anti plug and anti drill features means the cylinder offers excellent resistance to forced entry
- If attacked, a security pin automatically triggers blocking the cylinder cam preventing unlawful entry. The cylinder can still be operated from the inside with a key
- Meets the requirements of PAS 024 as part of a compliant doorset
- Approved by Sold Secure Diamond
- Independently tested to meet the latest British Standards BS EN 1303:2005 for security and awarded a BS Kitemark
- Dual colour cylinder with brass keyhole
- 6 trap pins for enhanced pick resistance
- Hardened pins for drill resistance
- 80,000 differs
- Available in Single, Double, Thumbturn and Keyed Alike options
- Each cylinder is supplied with 3 keys



Classification

The Fortress 3 Star cylinder has been approved to BS EN 1303:2005 and carries the following classification:

Category	1	2	3	4	5	6	7	8
Classification	1	6	0	0	0	C	5	0

British Standard 3 Star Anti Snap Euro Profile Cylinder

Ordering Details

Single

Dimensions			Finish	Part No.
A	B	C		
35	10	45	Dual	BS-FOR-3510-DC-1
40	10	50	Dual	BS-FOR-4010-DC-1
45	10	55	Dual	BS-FOR-4510-DC-1
50	10	60	Dual	BS-FOR-5010-DC-1
55	10	65	Dual	BS-FOR-5510-DC-1
60	10	70	Dual	BS-FOR-6010-DC-1

Double

Dimensions			Finish	Part No.
A	B	C		
35	35	70	Dual	BS-FOR-3535-DC-1
35	35	70	Dual	BS-FOR-3535-DC-TP2
35	40	75	Dual	BS-FOR-3540-DC-1
35	45	80	Dual	BS-FOR-3545-DC-1
40	40	80	Dual	BS-FOR-4040-DC-1
40	40	80	Dual	BS-FOR-4040-DC-TP2
40	45	85	Dual	BS-FOR-4045-DC-1
40	45	85	Dual	BS-FOR-4045-DC-TP2
40	50	90	Dual	BS-FOR-4050-DC-1
40	55	95	Dual	BS-FOR-4055-DC-1
40	55	95	Dual	BS-FOR-4055-DC-TP2
40	60	100	Dual	BS-FOR-4060-DC-1
45	45	90	Dual	BS-FOR-4545-DC-1
45	45	90	Dual	BS-FOR-4545-DC-TP2
45	50	95	Dual	BS-FOR-4550-DC-1
45	50	95	Dual	BS-FOR-4550-DC-TP2
45	55	100	Dual	BS-FOR-4555-DC-1
45	55	100	Dual	BS-FOR-4555-DC-TP2
50	50	100	Dual	BS-FOR-5050-DC-1
50	50	100	Dual	BS-FOR-5050-DC-TP2

Double Thumbturn

Dimensions			Finish	Part No.
A	B	C		
35	35	70	Dual	BS-FOR-T3535-DC-1
35	35	70	Dual	BS-FOR-T3535-DC-TP2
35	40	75	Dual	BS-FOR-T3540-DC-1
35	45	80	Dual	BS-FOR-T3545-DC-1
40	40	80	Dual	BS-FOR-T4040-DC-1
40	45	85	Dual	BS-FOR-T4045-DC-1
40	50	90	Dual	BS-FOR-T4050-DC-1
40	55	95	Dual	BS-FOR-T4055-DC-1
45	45	90	Dual	BS-FOR-T4545-DC-1
45	45	90	Dual	BS-FOR-T4545-DC-TP2
45	50	95	Dual	BS-FOR-T4550-DC-1
45	50	95	Dual	BS-FOR-T4550-DC-TP2
50	45	95	Dual	BS-FOR-T5045-DC-1
50	45	95	Dual	BS-FOR-T5045-DC-TP2
50	50	100	Dual	BS-FOR-T5050-DC-1
50	50	100	Dual	BS-FOR-T5050-DC-TP2
55	45	100	Dual	BS-FOR-T5545-DC-1

Key Blank

BS 3* Fortress Cylinder Key Blank	BS-FOR-KEYBLANK
-----------------------------------	-----------------

Fortress 3 Star BS Single Euro Profile Cylinder

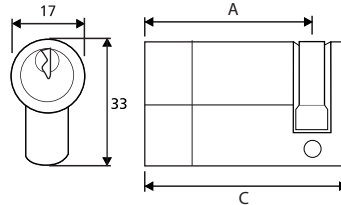

Fortress 3 Star BS Double Euro Profile Cylinder

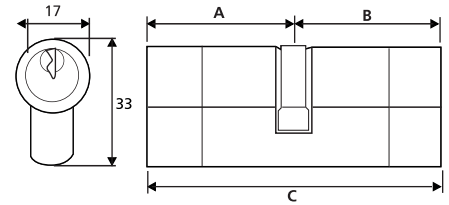

Fortress 3 Star BS Double Euro Profile Thumbturn Cylinder

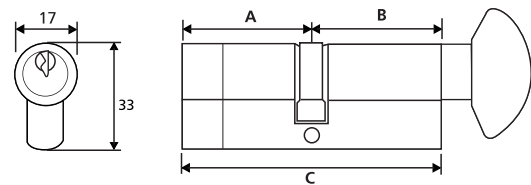

All dimensions are in mm and are nominal.
ERA reserves the right to change specification without notice.
It is the responsibility of the door manufacturer to ensure that the finished product meets any required safety and performance specification.

Maintenance

Wipe the surface periodically with a soft cloth to remove excess grease or moisture.

Packaging

Fortress 3 Star Cylinder
1 cylinder per box, 10 per outer box

Technical Information

Corrosion resistance
Meets the requirements of BS EN 1670:2007 Grade 3

Operation
Endurance tested in excess of 100,000 cycles

Performance (Excluding Thumbturn)
Independently tested to meet the requirements of BS EN 1303:2005 and accredited to TS007 3*. BSI Kitemark License No. 553031. Designed to meet the requirements of PAS 24 in a compliant door set.

Material Specification

Cylinder:	Brass
Cam:	Sintered Steel
Pins:	2 hardened pins, anti bump anti pick and anti-drill
Key:	Nickel plated brass
Screw:	M5 x 45mm and M5 x 70mm nickel plated screws
Finish:	Satin nickel plated brass with brass keyhole



Fortress Maximum Security Cylinder Fitting Instructions

Installing a Fortress Maximum Security Cylinder

This cylinder offers 3* resistance to many kinds of cylinder attack.

To be used in conjunction with a door handle to ensure enhanced resistance to all commonly used attack methods.

How to change your cylinder

On the open edge of the door look for the larger screw which falls in line with the bottom of the cylinder and remove screw.

With the key inserted into the cylinder, turn slightly while pulling to enable the cylinder to be removed.

To replace the cylinder reverse the above procedure.

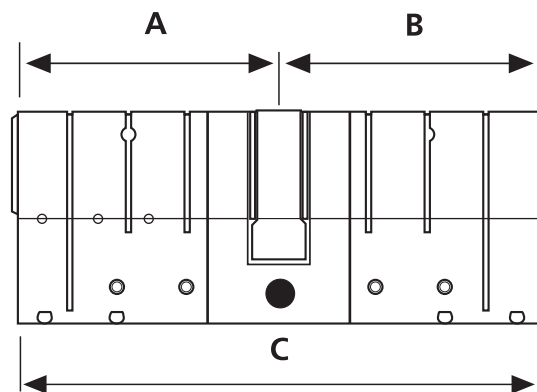

Cylinder Size Guide

- A** Measurement from the centre of the cam to point A (refer to above diagram)
- B** Measurement from the centre of the cam to point B (refer to above diagram)

Note: Your cylinder may be longer on one side than the other