

# GU32 IP65



## Emergency Twinflood from Channel Safety Systems



Emergency  
Lighting



# Emergency Twinspot

The GU32 IP65 is a cost effective emergency LED twin flood for both interior & exterior applications, our new GU IP65 twin flood offers a high performance, cost-effective emergency lighting in warehouses, factories, atriums, exterior escape routes & large open areas.

The GU32 IP65 gives 368Lm in the emergency mode.

High specification optic design and performance allows increased spacing providing reduced cost.

Supplied with hanging kit for downward pointing installation & integral driver and NiCd battery pack.

## Features

- Versatile multi-functional use, interior & exterior
- May be mounted in any orientation
- Tough polycarbonate housing
- Carrying handle for portability
- Non-maintained
- Minimal maintenance
- Easy installation
- IP65 ingress protection
- RoHS compliant
- Excellent luminaire spacings

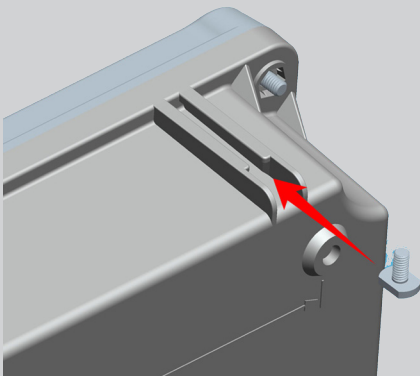

SPECIFICATIONS	
Light Source	SMT LED 2 x 30pcs
IP Rating	IP 65
Emergency Duration	3 hours (minimum)
Mains Voltage	230V 50Hz ± 10%
Mains Current	(max) 150mA (max) 40mA quiescent (3W)
Recharge Period	Less than 24 hour
Charge Indicator Integral green LED	Integral green charge & lamp healthy LEDs
Changeover Voltage	As per the requirements of BS EN 60598-2-22
Temperature Range	-5 to 40°C
Weight	1.08Kg
Battery	3.6V 3000mAh Nickel Cadmium
Material & Finish	Polycarbonate construction, white finish
Lumen Output	368Lm

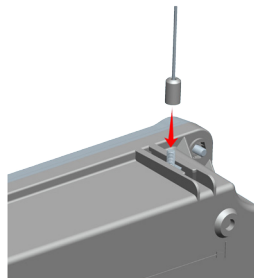

Hanging kit (supplied)



Luminaire Model	Mounting Height	Transverse distance to wall	Square Spacing	Axial to wall front of luminaire	Axial to wall rear of Luminaire
GU32 IP65 2 Head calculations, 30 deg & 30 deg	3m	2.5m	6.6m	5.0m	2.7m
	4m	2.7m	8.7m	6.0m	2.9m
	6m	3.4m	10.0m	7.2m	3.0m
	8m	4.3m	11.2m	8.0m	4.0m

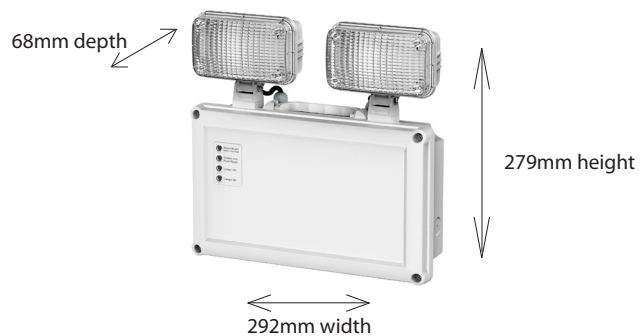

[www.channelsafety.co.uk](http://www.channelsafety.co.uk)

Tel: 0845 884 7000

Email: [sales@channelsafety.co.uk](mailto:sales@channelsafety.co.uk)

PRODUCT CODE	DESCRIPTION
E/GU32/IP65	IP65 3 Hour Non-Maintained emergency twin flood

Errors & omissions excluded. Specification is subject to change without notice.

revision 017-1