



PRESENCE SENSOR

60GHz mmWave radar

MMW-3W/(BK)
(wide)

MMW-3S/(BK)
(spot)

BENEFITS

- **Enhanced Security:**
Reliable detection of unauthorized presence and overstays.
- **Improved Safety:**
Enables proactive safety measures and timely responses to emergencies.
- **Energy Efficiency:**
Optimize lighting and HVAC systems based on actual occupancy.
- **Increased Convenience:**
Touchless operation for convenient and hygienic control.
- **Reduced False Alarms:**
Advanced filtering minimizes false triggers.



**This cutting-edge presence sensor detects even the finest of human motion, including subtle breathing.
No presence goes unnoticed, whether moving or stationary.**

UNPARALLELED SENSITIVITY

Millimeter Wave Radar detects the slightest human motion, including breathing.

ENVIRONMENTAL IMMUNITY

Unfazed by changes in ambient light and temperature, ensuring reliable and consistent detection.

TOUCHLESS SWITCH MODE

Configurable for touchless operation with a detection distance of 0.2 meters.

SIMPLE & DISCREET DESIGN

Blends seamlessly into any environment, suitable for both ceiling and wall installations.

FALSE ALARM IMMUNITY

Detection distance is adjustable in 16 patterns from 0.2 meters to 3.5 meters and incorporates an on-delay timer function for effective false alarm suppression and overstay detection.

APPLICATIONS

Enhances security in high-risk areas like prisons and government facilities, enables patient monitoring and improved care in healthcare settings, assists with loss prevention and customer behavior analysis in retail, and empowers smart homes with enhanced security and automated control.

EASY INTEGRATION

Detection output selectable (N.C./N.O., changeover) for seamless integration with existing systems, includes a dedicated terminal for interconnecting multiple units.

PRESENCE SENSOR

■ DETECTION AREA (Roughly illustrated)

(Unit : m)

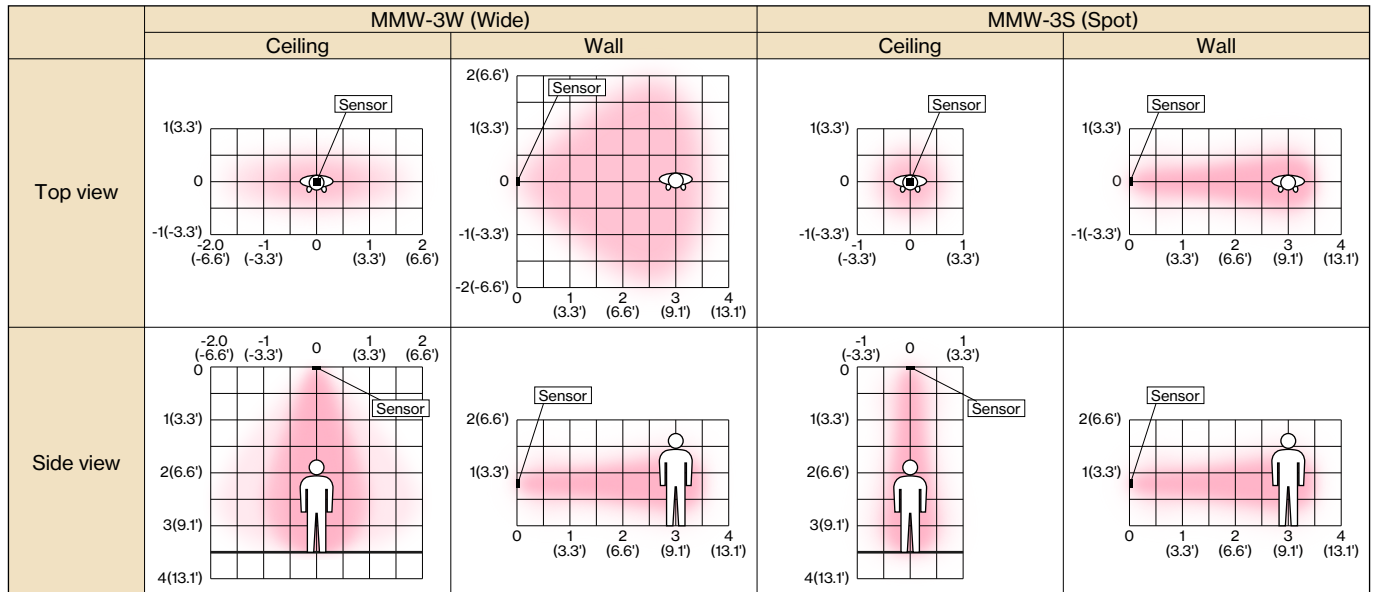

■ SPECIFICATIONS

Description	Presence sensor	
Model	MMW-3W/(BK)	MMW-3S/(BK)
Area	Wide	Spot
Supply voltage	9 to 28V DC (non-polarity)	
Current consumption	40mA max.	
Frequency	60GHz	
Detection distance	3.5m (11.5') max. (16 patterns)	
Alarm output	Contact : Dry contact N.C./N.O. selectable Operation : Continuous output during detection *at least 2sec. Capacity : 30V (DC/AC) 0.2A (resistive load)	
Trouble output	Contact : Dry contact N.C. Operation : Output at low voltage or malfunction Capacity : 30V (DC/AC) 0.2A (resistive load)	
Tamper output	Contact : Dry contact N.C. Operation : Output at the cover removed Capacity : 30V (DC/AC) 0.1A (resistive load)	
LED operation	Powered : Blue lighting (1sec.) Standby : Blue lighting Detection : Red lighting Trouble : Red blinking Memory : Yellow blinking(3min.), lighting(47min.), automatically OFF	
On-delay timer	4 patterns (none, 10sec., 15min., 30min.)	
Functions	LED Indicator, Memory LED ON/OFF, Sensitivity, On-delay, Installation environment, Buzzer, Distance setting, Tamper	
Mounting	Indoor : Ceiling / Wall	
Ambient temperature	-25°C to +50°C (-13°F to +122°F) without condensation	
Connection	Screwless terminal	
Weight	160g (5.6oz)	
Appearance	Resin (cover : white / black(BK), main unit : gray)	

*Specifications and design are subject to change without prior notice.

■ EXTERNAL DIMENSIONS

(Unit : mm)

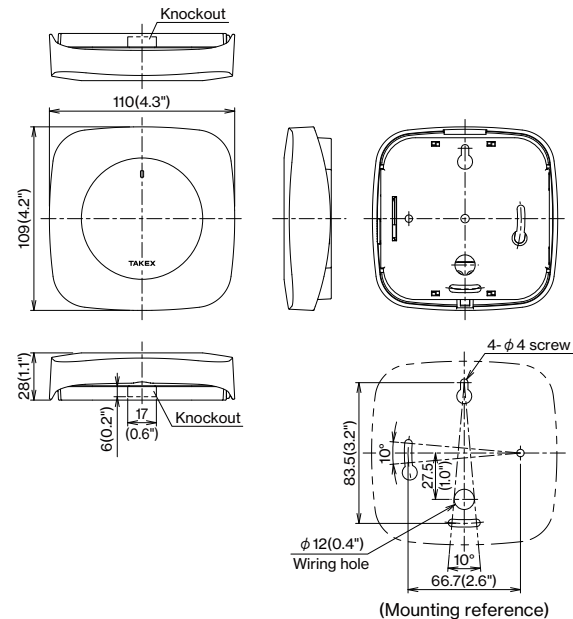

■ OPTIONS

● Ceiling/Wall Attachment

<BCW-401>



<BCW-401(BL)>



*Black

Limited Warranty :

TAKEX products are warranted to be free from defects in material and workmanship for 12 months from original date of shipment. Our warranty does not cover damage or failure caused by Acts of God (including inductive surge by lightning), abuse, misuse, abnormal usage, faulty installation, improper maintenance or any repairs other than those provided by TAKEX. All implied warranties with respect to TAKEX, including implied warranties for merchantability and implied warranties for fitness, are limited in duration to 12 months from original date of shipment. During the Warranty Period, TAKEX will repair or replace, at its sole option, free of charge, any defective parts returned prepaid. Please provide the model number of the products, original date of shipment and nature of difficulty being experienced. There will be charges rendered for product repairs made after our Warranty period has expired.



In Japan

TAKENAKA ENGINEERING CO., LTD.
83-1, Gojo-Dori, Sotokan Nishi-iru, Higashino,
Yamashina-ku, Kyoto 607-8156, Japan
Tel : 81-75-501-6651

<https://www.take-ex-eng.co.jp/>

In the U.S.

TAKEX AMERICA INC.
1810 Oakland Rd, Suite F,
San Jose, CA 95131, USA
Tel : +1-408-747-0100

<https://www.take-ex.com>

In Australia

TAKEX AMERICA INC.
4/15 Howleys Road Notting Hill
VIC 3168
Tel : +61-(0)3-9544-2477

<https://www.take-ex.com>

In the U.K.

TAKEX EUROPE LTD.
Aviary Court Wade Road Basingstoke
Hampshire RG24 8PE UK
Tel : +44-(0)1256-475555

<https://www.take-ex.com>