

# Wireless Manual Call Point (RF-805)



The Wireless Manual Call Point (RF-805) is a *plexus* device that allows a manual trigger of fire in a Vigilon fire detection and alarm system.

### Compatibility

The Wireless MCP is designed to work with Loop Radio Transceiver (LRT) connected to a Vigilon device loop. The Vigilon panel must have:

- MCC ≥ V4.45 and LPC ≥ V4.43
- ≥ - means equal to or greater than

### Batteries

This *plexus* device must only be operated with approved and recommended batteries Part No. 805597 - SAFT Batteries LS14500 (pack of 4). The lifetime of the batteries is dependent on the device type, the ambient operating temperature and other area environmental conditions. The batteries can be stored up to a maximum of 3 years from the date of manufacture.

### Technical Data

Designed to Standards	EN54-25:2008 EN54-11:2001
Battery	SAFT - 4 x 3.6V Lithium batteries - LS14500
Frequency band	868 MHz SRD (14 Channels)
Range	Up to 100m
Dimensions in mm	135 height x 135 width x 50mm excluding fixing plate
Weight	306g <i>Main assembly</i> 62g <i>Wall mounting plate</i> 16g per battery (4 required)
Colour	Red RAL3020
Enclosure material	PC/ASA plastic
Storage temperature	MCP w/o batteries -20°C to +60°C batteries -20°C to +30°C
Ambient operating temperature	-10°C to +55°C
Relative Humidity	up to 95% - non condensing
Ingress Protection	IP31
Devices per LRT	up to 31 (excludes the LRT)
Indication	Red LED

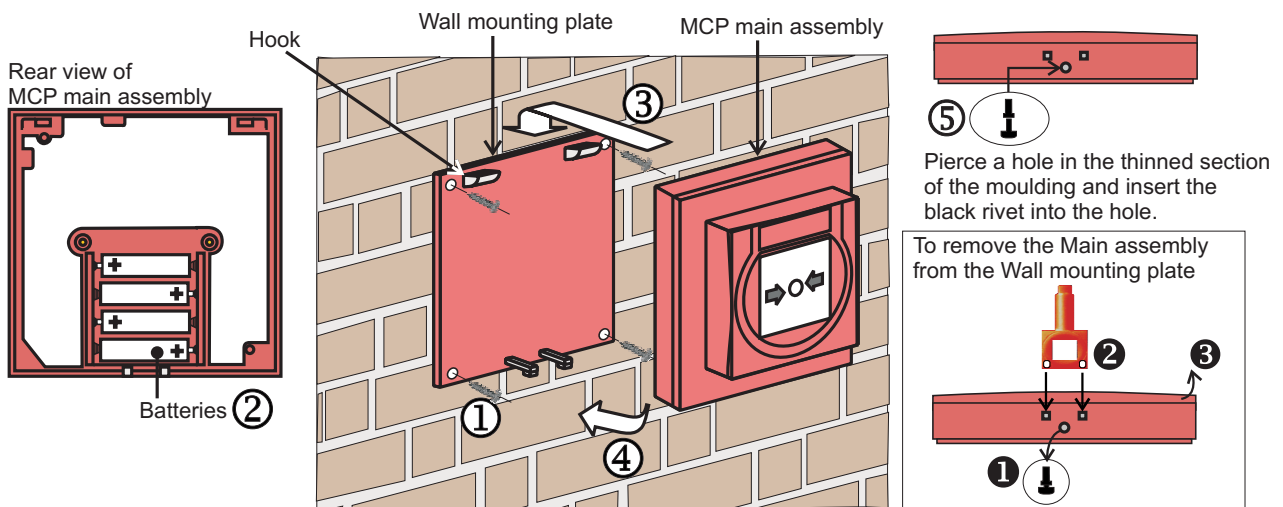

**Installation**

**Do's**

- DO install the *Wireless MCP* such that the mounting locations are as recommended in BS5839 Part 1 and..
- DO ensure a Site Survey has been carried out and the 'as fitted drawings' show the exact location of *plexus* devices.
- DO use all the screw fixing points provided on the *Wall mounting plate* to secure it to a flat wall surface.

**Don'ts**

- DO NOT use adhesive to fix the *Wall mounting plate*.
- DO NOT install *plexus* devices to include LRTs within 0.3m distance from each other.
- DO NOT mix old and new batteries. Always replace the entire battery set.

- a. Detach the *Wall mounting plate* from the *MCP main assembly*, see section headed 'Dismantle'.
- b. With hooks in the upper 'top' position, fix the *Wall mounting plate* to a flat wall surface using suitable screws and all four fixing points ①.

**Commissioning overview**

The *Wireless MCP* is programmed to work with an LRT, that is wired to a Vigilon Device Loop. The programming is done using the Plexus tool and Vigilon commissioning tool.

- Connect the LRT to loop and power up
- Retrieve the factory settings from LRT using the Plexus tool and pre allocate the LRT
- One at a time power up the *plexus* devices associated with the LRT
- Pre allocate each *plexus* device with the Plexus tool to work with the associated LRT.

**How to power up a Wireless MCP**

- a. Fit the 4 batteries ② (Part No. 805597) in their correct orientations into the back of the *MCP main assembly*.



**There is a risk of an explosion if the battery contacts are shorted or if replaced by an incorrect battery type.**

- b. The device is now ready to operate.
- c. Hook the *MCP main assembly* onto the top two **hooks** ③ of the *Wall mounting plate* and then close the *MCP main assembly* ④ until a click is heard and the unit locks into a closed position.

**Emergency operation**

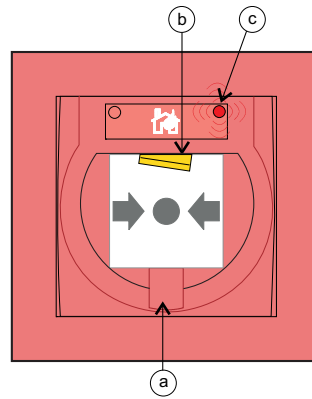

Press the centre inwards to activate the call point, the yellow tab 'b' will become visible and the red LED 'c' will flash.

**Resetting the Resettable element**

Slide the cover 'a' upwards to expose the key hole. Insert the test key in the keyhole and turn it clockwise a quarter turn. Then turn the test key anticlockwise a quarter turn to reset the call point.

**Maintenance**

The remaining capacity of the batteries is checked automatically and a fault is displayed on the panel when the batteries need to be replaced. The batteries must be replaced within 14 days of the fault message.



**Disposal of the used batteries must be in accordance with recommendations of the battery manufacturer and local regulations.**

**Dismantle**

To dismantle the *MCP main assembly* from the *Wall mounting plate*, insert the key pins into the two openings on the base of the *MCP main assembly*. Press the key to disengage the catch and lift open from the bottom side the *MCP main assembly* from the *Wall mounting plate*.

**CE**  
0359

Gent by Honeywell  
Hamilton Industrial Park,  
140 Waterside Road,  
Leicester LE5 1TN, UK

<b>Product No.</b> RF-805	<b>EC Certification of Conformity No.</b> 0359-CPD-0133
------------------------------	--



At the end of their useful life, the packaging, product and batteries should be disposed of via a suitable recycling centre and in accordance with national or local legislation.



**WEEE Directive:**  
At the end of their useful life, the packaging, product and batteries should be disposed of via a suitable recycling centre.  
Do not dispose of with your normal household waste. Do not burn.

Gent by Honeywell reserves the right to revise this publication from time to time and make changes to the content hereof without obligation to notify any person of such revisions of changes.

<b>GENT</b> by Honeywell	Hamilton Industrial Park, Waterside Road, Leicester LE5 1TN, UK Telephone +44 (0) 116 246 2000	Website: <a href="http://www.gent.co.uk">www.gent.co.uk</a> Fax (UK): +44 (0)116 246 2300
Technical support: <a href="http://www.gentexpert.co.uk">www.gentexpert.co.uk</a>		