

# MS10SSU MINI MAGNET SIDE OR FACE FIXING

## Outward Opening Doors

- 1) Offer up to the door and frame the Magnet and Armature assembly to check for position on the underside of the door frame and the wire exit routing.
- 2) Mark the position for the fixing bracket by either measuring 18mm from the face of the door to the Magnet face by using the Armature plate with its flexible mounting rubber washers as a spacer.
- 3) Remove mounting plate from the Magnet and screw firmly into position on the door frame. Make sure that this is parallel to the door face when closed.
- 4) Drill wire exit and refix Magnet to the mounting plate after guiding the cable through and connecting up to the power supply. 12v 250mA or 24v 500mA required.
- 5) With power applied the Armature can be placed on the face of the Magnet ensuring it is exactly central in both planes giving the necessary overlap for full holding force. By now closing the door onto the Armature, the position for the anti-rotation pins can be marked. From these, the central fixing screw position can be found.
- 6) Drill 7mm dia. x 10mm deep holes for anti-rotation pins and either 8mm dia. hole for the central screw assuming a solid door construction or a 12.7mm dia. hole when using the spacer tube for hollow doors.

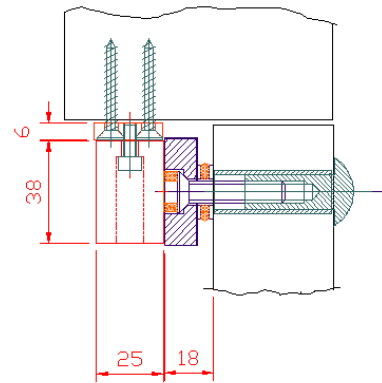
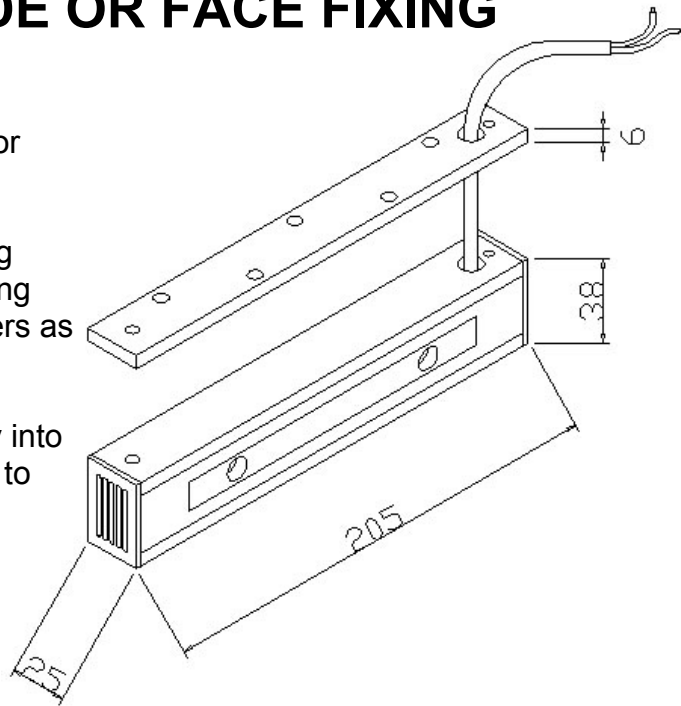

MS-10  
OUTWARD  
OPENING

## Inward Opening Doors

- 1) In this case a Z & L bracket will be needed. Order code **MS10Z** and **MS10L** Brackets
- 2) Fit the L bracket to the Magnet and the Z bracket to the Armature and offer up the assembly to the door and frame to determine the best position for both. Approx 200mm from the leading edge of the door to the centre line of the Magnet is a good guide. Make sure the door and frame have substantial fixing points.
- 3) Fit the L bracket to the frame, then fit the Magnet and connect to the power supply. Offer up the Armature and Z Bracket. When exactly central, loosely adjust the Z bracket to allow its fixing points to be marked on the door, then firmly fixit with screws provided.
- 4) In certain circumstances it is possible to dispense with the L bracket and fix through the Magnet by first drilling out the blind counter bored holes. This is normally only possible when the door is recessed below the frame.
- 5) Make sure the Magnet and Armature are set so they do not become the door stop. Tighten fixings firmly.

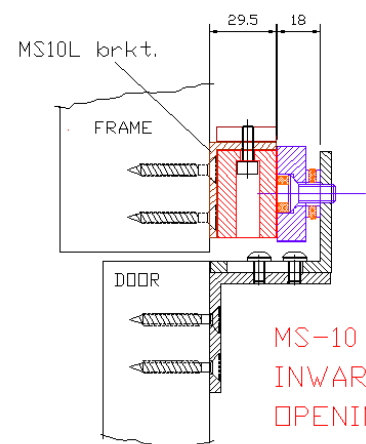

MS-10  
INWARD  
OPENING

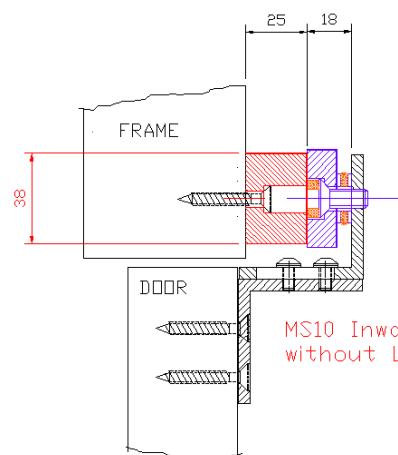

MS10 Inward Opening  
without L bracket